



## Chosse drain for piece list on page one!

DN 100

**LX1840-4X****Series 88**

Drain Art.-No. 01491.100X

Weight: 6,8 kg

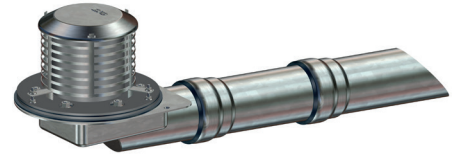
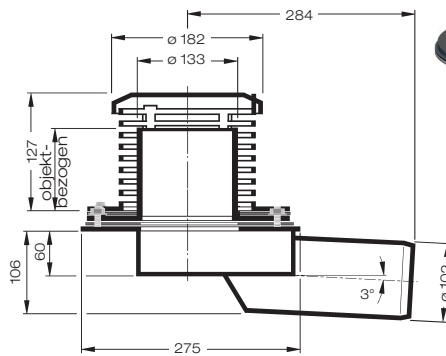
**without raised edge**with clamping flange for bituminous  
and plastic roofing sheets**LORO-X Spout**

made of galvanised steel, DN 100

Art.-No. 15199.100X

Weight: 1,4 kg



**Heat tracing:** Lorowerk recommends to check all drains and pipes with regard to their frost-sensibility. Where necessary, these parts should be upgraded with heat tracing.